

## ROZVODNÉ SKRINE

Plastové rozvodné skrine

### Rozvodné skrine nadomietkové



| TRACON    |            | $\times 17.5$ | H (mm) | W (mm) | D (mm) |
|-----------|------------|---------------|--------|--------|--------|
| EDFK-4/1  | EDFKN-4/1  | 4             | 200    | 110    | 70     |
| EDFK-6/1  | EDFKN-6/1  | 6             | 205    | 150    | 75     |
| EDFK-8/1  | EDFKN-8/1  | 8             | 205    | 190    | 75     |
| EDFK-12/1 | EDFKN-12/1 | 12            | 205    | 260    | 75     |
| EDFK-12/2 | EDFKN-12/2 | 24            | 330    | 270    | 75     |
| EDFK-14/3 | EDFKN-14/3 | 42            | 475    | 310    | 85     |
| EDFK-18/1 | EDFKN-18/1 | 18            | 220    | 365    | 75     |

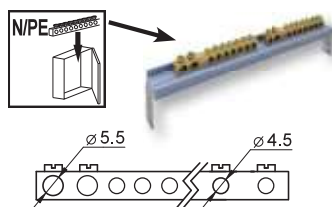

RELEVANT STANDARD  
EN 62208

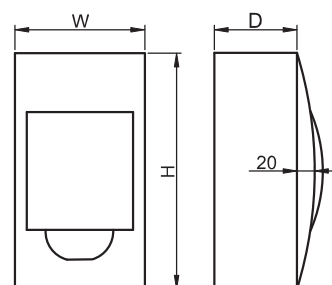

### Rozvodné skrine podomietkové



| TRACON   |           | $\times 17.5$ | H <sub>1</sub> (mm) | W <sub>1</sub> (mm) | D <sub>1</sub> (mm) | H <sub>2</sub> (mm) | W <sub>2</sub> (mm) | D <sub>2</sub> (mm) |
|----------|-----------|---------------|---------------------|---------------------|---------------------|---------------------|---------------------|---------------------|
| EDS-4/1  | EDSN-4/1  | 4             | 200                 | 115                 | 60                  | 210                 | 135                 | 20                  |
| EDS-6/1  | EDSN-6/1  | 6             | 200                 | 160                 | 60                  | 210                 | 170                 | 20                  |
| EDS-8/1  | EDSN-8/1  | 8             | 215                 | 200                 | 60                  | 220                 | 225                 | 20                  |
| EDS-12/1 | EDSN-12/1 | 12            | 200                 | 260                 | 60                  | 220                 | 280                 | 20                  |
| EDS-12/2 | EDSN-12/2 | 24            | 320                 | 270                 | 70                  | 350                 | 300                 | 20                  |
| EDS-14/3 | EDSN-14/3 | 42            | 475                 | 310                 | 75                  | 500                 | 340                 | 20                  |
| EDS-18/1 | EDSN-18/1 | 18            | 240                 | 380                 | 70                  | 255                 | 400                 | 20                  |

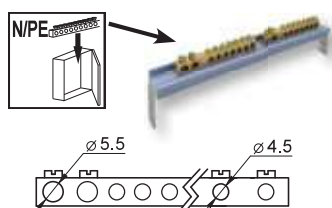

RELEVANT STANDARD  
EN 62208

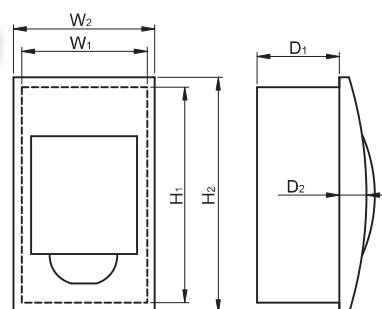

H/2

TRACON  
ELECTRIC®